

NOTE: BREAK ALL CORNERS WITH 0.015" (.38 MM) RADIUS UNLESS OTHERWISE NOTED. STANDARD TOLERANCES TO APPLY UNLESS OTHERWISE SPECIFIED.

CUSTOMER PART No.	<b>CAN ART STD.</b>	DIE No. <b>ES05762</b>
DESCRIPTION	0.625 x 0.750 CHANNEL	PROPOSAL No. <b>S-12383</b>

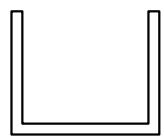
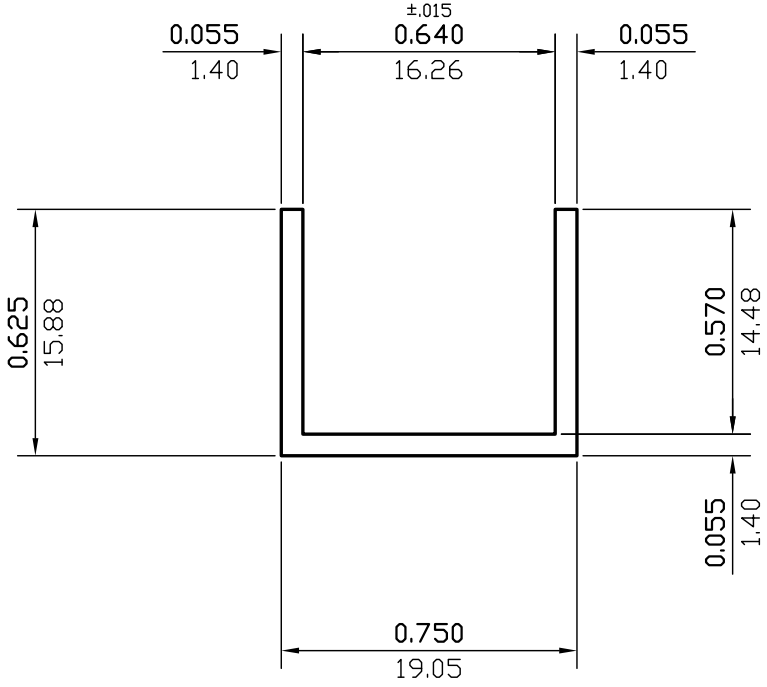

ACTUAL SIZE

WALL THICKNESS **0.055 (1.40)** EXCEPT AS SHOWN

DATE	REV	DESCRIPTION	BY
03/20/23	1	REMOVED ALLOY	JASON
EST. AREA	0.104	IN. <sup>2</sup>	EST. AREA 67.065
			MM. <sup>2</sup>
EST. WT.	0.123	LBS./FT.	EST. WT. 0.183
			KG/M.
EST. PER.	3.890	IN.	EST. PER. 98.806
			MM.
OUT PER.		IN.	OUT PER.
			MM.
C.C.D.	0.976	IN.	C.C.D. 24.798
			MM.
FACTOR	32	FINISH	M/F
		ALLOY & TEMP.	
CKD BY	SCALE 2:1	DWN BY	P.M. DATE 05/14/2002

# CAN ART

ALUMINUM EXTRUSION INC.

85 PARKSHORE DRIVE  
BRAMPTON, ONT L6T 5M1  
TEL. NO. (905) 791-1464  
FAX NO. (905) 791-9151  
E-MAIL: canart@canart.com

THIS DRAWING IS NOT NECESSARILY A COPY OF YOUR ORIGINAL. PLEASE APPROVE DIMENSIONS AND TOLERANCES INDICATED. CAN ART ASSUMES NO RESPONSIBILITY EITHER TECHNICAL OR LEGAL FOR HAVING THIS SHAPE MADE. THE CUSTOMER AGREES TO FULLY PROTECT CAN ART ALUMINUM FROM CLAIMS OF OTHERS RESULTING FROM THIS SHAPE.

SIGNED: \_\_\_\_\_ DATE: \_\_\_\_\_